

GAE NT Fuses



APPLICATIONS

- Protections against overload and short circuit in electric lines (type gG)
- Rated voltage up to 690V
- Rated current up to 1250A
- Rated breaking capacity up to 100kA
- Working frequency 50Hz AC
- Compliant to GB13539 and IEC269

DESIGN FEATURES

Variable cross-section fuse element made from *pure copper* or *silver plated* sealed in cartridge made from *high-duty ceramic*.
 Fuse tube filled with chemically treated *high-purity quartz sand* as arch extinguisher.
Dot-welding of fuse element end to the terminal ensures reliable connection and form insert knife type contact. Indicator or sticker may be attached to the fuse link to show when cutting fuse off or to give various signal and to cut the circuit automatically.

CURVA CHARACTERISTICS

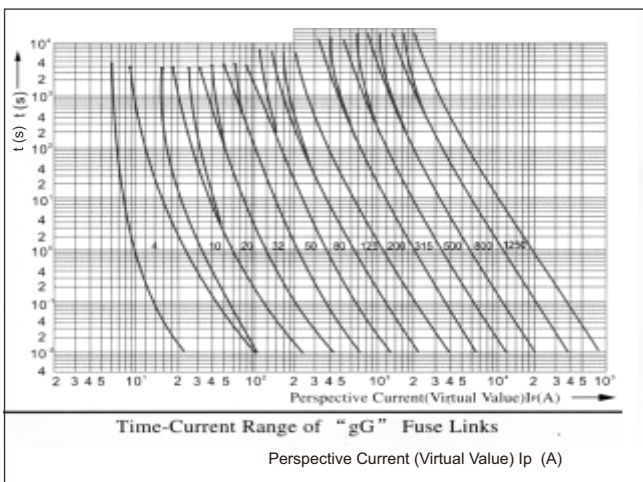

Breaking Current Characteristics Curve of "gG" Fuse Links

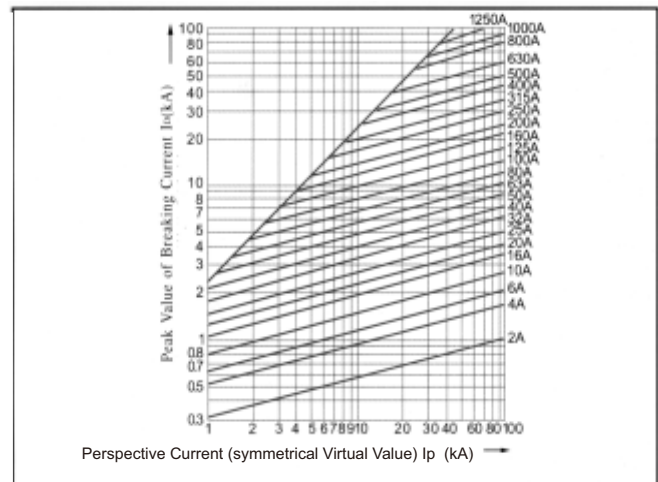

Breaking Current Characteristics Curve of "gG" Fuse Links

NT Fuses

Rated voltage : 690V
 Rated breaking capacity : 100kA
 Class : gl-gL-gG
 Material insulator : ceramics

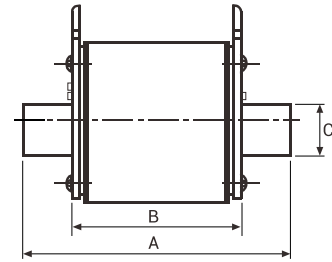
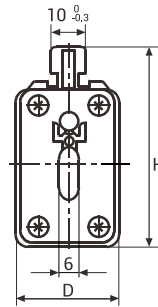

Type	Ampere	Dimension					Weight (g/pcs)	Code no.
		A	B	C	D	H		
NT 00	6	78	50.5	15	30	60	201	240101006
	10	78	50.5	15	30	60	201	240101012
	16	78	50.5	15	30	60	201	240101018
	20	78	50.5	15	30	60	201	240101024
	25	78	50.5	15	30	60	201	240101030
	32	78	50.5	15	30	60	201	240101036
	35	78	50.5	15	30	60	201	240101042
	40	78	50.5	15	30	60	201	240101048
	50	78	50.5	15	30	60	201	240101054
	63	78	50.5	15	30	60	201	240101060
	80	78	50.5	15	30	60	201	240101066
	100	78	50.5	15	30	60	201	240101072
	125	78	50.5	15	30	60	201	240101078
160	78	50.5	15	30	60	201	240101084	



Type	Ampere	Dimension					Weight (g/pcs)	Code no.
		A	B	C	D	H		
NT 0	50	125	67	15	30	60	267	240102006
	63	125	67	15	30	60	267	240102012
	80	125	67	15	30	60	267	240102018
	100	125	67	15	30	60	267	240102024
	125	125	67	15	30	60	267	240102030
	160	125	67	15	30	60	267	240102036

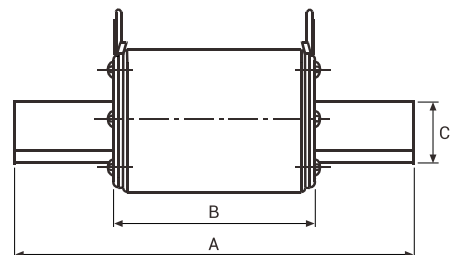
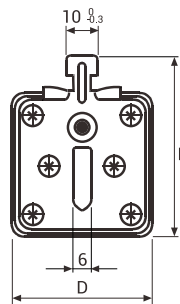

Type	Ampere	Dimension					Weight (g/pcs)	Code no.
		A	B	C	D	H		
NT 1	50	135	67	20	46	58.5	447	240103006
	63	135	67	20	46	58.5	447	240103012
	80	135	67	20	46	58.5	447	240103018
	100	135	67	20	46	58.5	447	240103024
	125	135	67	20	46	58.5	447	240103030
	160	135	67	20	46	58.5	447	240103036
	200	135	67	20	46	58.5	447	240103042
	224	135	67	20	46	58.5	447	240103048
	250	135	67	20	46	58.5	447	240103054

NT Fuses

Rated voltage : 690V
 Rated breaking capacity : 100kA
 Class : gl-gL-gG
 Material insulator : ceramics

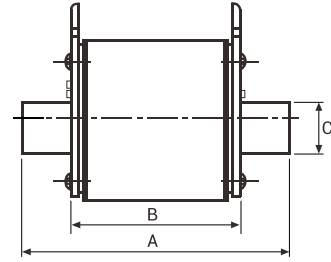
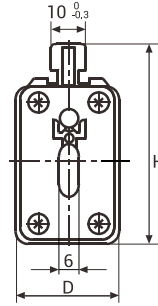

Type	Ampere	Dimension					Weight (g/pcs)	Code no.
		A	B	C	D	H		
NT 2	250	150	68	20	58.5	68.5	727	240104006
	300	150	68	20	58.5	68.5	727	240104009
	315	150	68	20	58.5	68.5	727	240104012
	355	150	68	20	58.5	68.5	727	240104018
	400	150	68	20	58.5	68.5	727	240104024



Type	Ampere	Dimension					Weight (g/pcs)	Code no.
		A	C	D	H			
NT 3	355	150	68	36	70	82	975	240105006
	400	150	68	36	70	82	975	240105012
	425	150	68	36	70	82	975	240105018
	500	150	68	36	70	82	975	240105024
	630	150	68	36	70	82	975	240105030

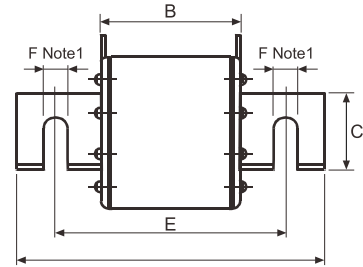
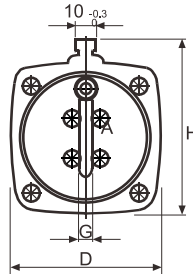

Type	Ampere	Dimension								Weight (g/pcs)	Code no.
		A	B	C	D	G	E	F	H		
NT 4	800	200	90	50	97	8	150	16.5	113	2716	240106006
	1000	200	90	50	97	8	150	16.5	113	2716	240106012
	1250	200	90	50	97	8	150	16.5	113	2716	240106018