

JIS Thin Wall conduit fitting

(Unit : mm)

Couplings

- Sheet steel finished with zinc plating

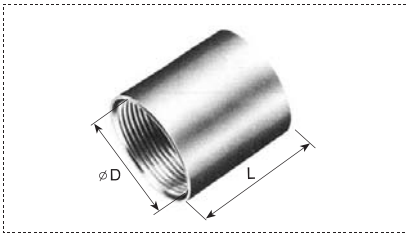

Cat. No.	Nominal Size	D	L	Weight (kg/pack)	Standard Pack (pcs)
DF1119T	19	23	28	15.00	500
DF1125T	25	29.3	34	15.00	300
DF1131T	31	36	38	14.00	200
DF1139T	39	42.5	42	20.00	200
DF1151T	51	56	48	16.00	100
DF1163T	63	70	54	13.00	50
DF1175T	75	83	60	18.00	50

Normal Bends

- Sheet steel finished with zinc plating

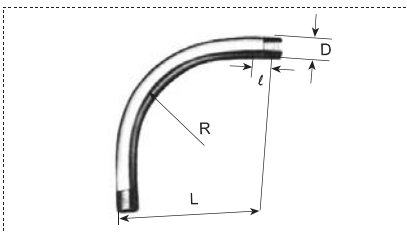

Cat. No.	Nominal Size	D	I	L	R	Weight (kg)
DF1119	25	25.4	16	170	120	0.27
DF1125	31	31.8	18	210	150	0.34
DF1131	39	38.1	20	255	180	0.58
DF1139	51	50.8	23	330	230	0.01
DF1151	63	63.5	26	410	290	2.06
DF1163	75	76.2	29	500	350	3.13

Circular surface boxes (one way)

- Sheet steel finished with zinc plating

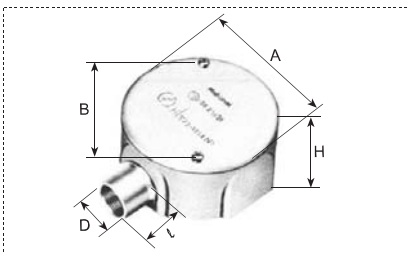

Cat. No.	Nominal Size	H	A	B	I	D	Weight (kg)
DF25191	19	40.5	89.5	73	20	23	0.38
DF25251	25	40.5	89.5	73	22	29.5	0.39
DF25311	31	45	100	84	23	36	0.49

Circular surface boxes (one way ; through)

- Sheet steel finished with zinc plating

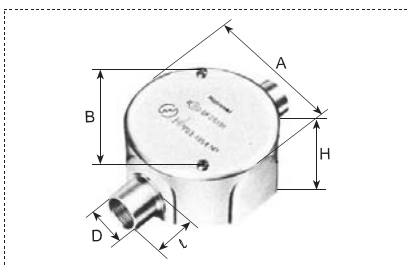

Cat. No.	Nominal Size	H	A	B	I	D	Weight (kg)
DF26191	19	40.5	89.5	73	20	23	0.41
DF26251	25	40.5	89.5	73	22	29.5	0.42
DF26311	31	45	100	84	23	36	0.54

Circular surface boxes (two way ; angle)

- Sheet steel finished with zinc plating

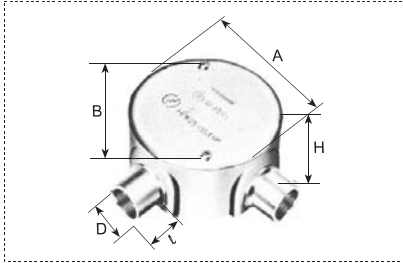

Cat. No.	Nominal Size	H	A	B	l	D	Weight (kg)
DF29191	19	40.5	89.5	73	20	23	0.41
DF29251	25	40.5	89.5	73	22	29.5	0.42
DF29311	31	45	100	84	23	36	0.54

Circular surface boxes (three way)

- Sheet steel finished with zinc plating

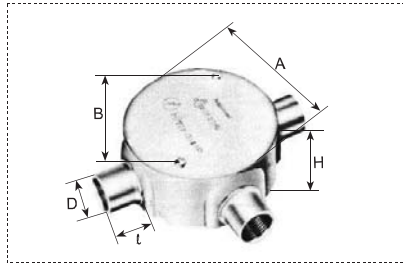

Cat. No.	Nominal Size	H	A	B	l	D	Weight (kg)
DF27191	19	40.5	89.5	73	20	23	0.45
DF27251	25	40.5	89.5	73	22	29.5	0.46
DF27311	31	45	100	84	23	36	0.58

Circular surface boxes (four way)

- Sheet steel finished with zinc plating

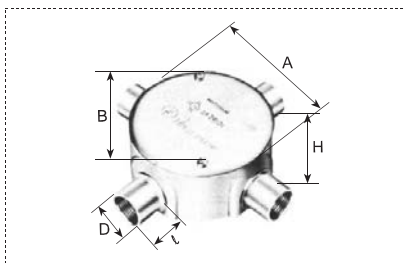

Cat. No.	Nominal Size	H	A	B	l	D	Weight (kg)
DF28191	19	40.5	89.5	73	20	23	0.48
DF28251	25	40.5	89.5	73	22	29.5	0.49
DF28311	31	45	100	84	23	36	0.63

Universal LL type

- Sheet steel finished with zinc plating

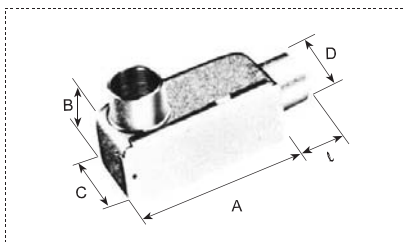

Cat. No.	Nominal Size	A	B	C	D	l	Weight (kg)
DF22191	19	90	33.8	35	23	20	0.24
DF22251	25	95	40.8	42	29.5	22	0.33
DF22311	31	110	47.5	45.8	36	22	0.425

Universal LB type

- Sheet steel finished with zinc plating

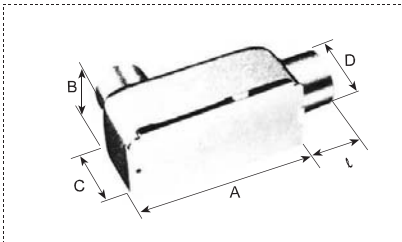

Cat. No.	Nominal Size	A	B	C	D	l	Weight (kg)
DF23191	19	90	33.8	35	23	20	0.24
DF23251	25	95	40.8	42	29.5	22	0.33
DF23311	31	110	47.5	45.8	36	22	0.42

Universal T type

- Sheet steel finished with zinc plating

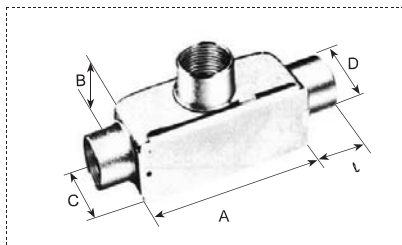

Cat. No.	Nominal Size	A	B	C	D	l	Weight (kg)
DF24191	19	90	33.8	35	23	20	0.27
DF24251	25	95	40.8	42	29.5	22	0.37
DF24311	31	110	47.5	45.8	36	22	0.45

Bushings

- Cast iron with zinc-electroplating

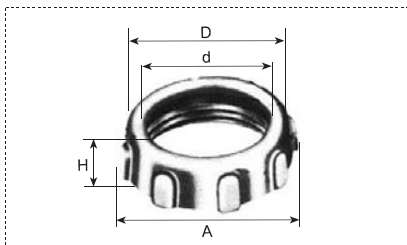

Cat. No.	Nominal Size	d	A	H	D	Weight (kg)
DS1419	19	16	26.5	9	23	0.01
DS1425	25	22	33	10	30	0.02
DS1431	31	29	41	11	36	0.03
DS1439	39	35	46	12	43	0.04
DS1451	51	48	60	15	57	0.05
DS1463	63	60	74	17	70	0.10
DS1475	75	72	88	20	83	0.18

Plastic bushing with caps

- Plastic

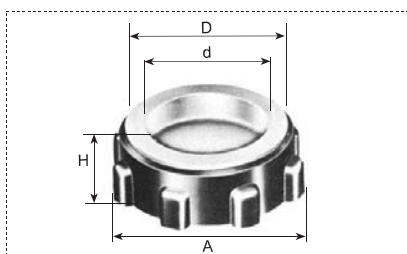

Cat. No.	Nominal Size	d	A	H	D	Weight (kg)
DS1719	19	15.7	27	9	23	0.002
DS1725	25	21.8	33	10	30	0.004
DS1731	31	28	41	11	36	0.006
DS1739	39	34.7	49	12	43	0.008
DS1751	51	47.4	64	15	57	0.016
DS1763	63	59.2	78	17	70	0.024
DS1775	75	71.9	92	20	83	0.036

Reducers

- Cast iron with zinc-electroplating

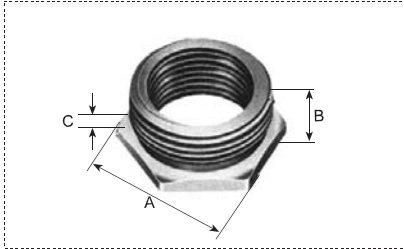

Cat. No.	Nominal Size	A	B	C	Weight (kg)
DF5225	25 - 19	28	15.17	4	0.024
DF5231	31 - 25	35	.5	4	0.040
DF5239	39 - 31	43.5	20	4.5	0.054
DF5251	51 - 39	52.5	21.5	5	0.080

Lock nuts

- Sheet steel with zing electroplating

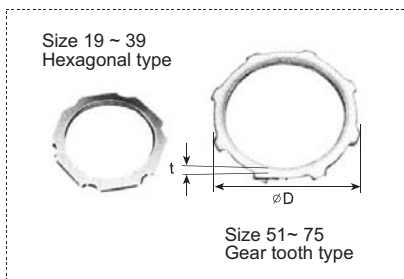

Cat. No.	Nominal Size	D	t	Weight (kg)
DS1219	19	24	3.2	0.005
DS1225	25	31.5	3.2	0.007
DS1231	31	38	3.6	0.013
DS1239	39	45	3.6	0.017
DS1251	51	65	5	0.033
DS1263	63	79	5	0.042
DS1275	75	93	5	0.054

Saddles

- Sheet steel with zing electroplating

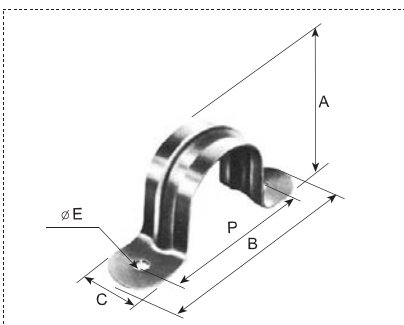

Cat. No.	Nominal Size	A	B	C	P	E	Weight (kg)
DS1619	19	17.6	60	15	40	5	0.009
DS1625	25	23.9	70	20	50	5	0.014
DS1631	31	30.3	85	25	60	5.5	0.029
DS1639	39	36.6	95	25	70	5.5	0.032
DS1651	51	49.3	110	25	85	5.5	0.055
DS1663	63	62.0	130	25	105	5.5	0.065
DS1675	75	47.7	150	30	120	6.5	0.090